

M. Residence, Cedar City, Utah
 P. m. Landscape Design, Cedar City, Utah

ATOMIC RANCH

Master Plan

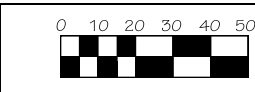

Scale:
 1" = 20'

Flower Garden Detail

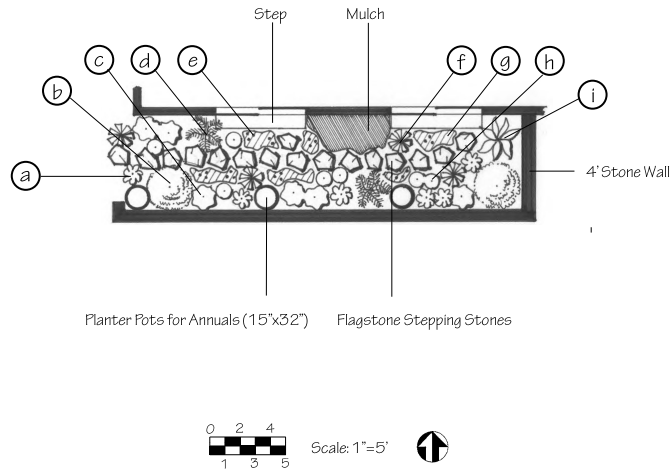

Flower Garden Plant Schedule

Label	Botanical Name	Common Name	Size	Color	Quantity
a	<i>Astilbe chinensis 'Maggie Daley'</i>	Astilbe	1 bulb	lavender-pink	6
b	<i>Dicentra spectabilis 'Gold Heart'</i>	Gold Heart Bleeding Heart	4" cup	pink	2
c	<i>Anemone hupehensis</i>	Japanese Anemone	1 start	pink	6
d	<i>Polystichum acrostichoides</i>	Christmas Fern	small pot	--	2
e	<i>Narcissus</i>	Daffodils	1 bulb	yellow/white	23
f	<i>Artemisia marschalliana</i>	Filigree Daisy	7cx9c pot	yellow	4
g	<i>Lamium maculatum</i>	'Dead Nettle' Lamium	4" cup	pink	10
h	<i>Aquilegia caerulea</i>	Rocky Mountain Columbine	4" cup	blue	7
i	<i>Athyrium 'Ghost'</i>	Ghost Fern	quart	--	1

Master Plan Plant Schedule

Label	Botanical Name	Common Name	Size	Color	Quantity
A	<i>Gymnocladus dioica</i>	Kentucky Coffee Tree	#15 pot	--	1
B	<i>Perovskia atropicifolia</i>	Russian Sage	4" pot	blue	10
C	<i>Rhus aromatica 'Gro-Low'</i>	Gro-Low Sumac	5" pot	--	7
D	<i>Calamagrostis x acutiflora 'Karl Foerster'</i>	Karl Foerster Feather Reed Grass	#2 pot	--	40
E	<i>Buchloe dactyloides 'Cody'</i>	Cody Buffalo Grass	3 lbs	--	1
F	<i>Malus domestica 'Honeycrisp'</i>	Honeycrisp Apple	5 gal	--	1
G	<i>Malus domestica 'Gala'</i>	Gala Apple	5 gal	--	1
H	<i>Juniperus scopulorum 'Skyrocket'</i>	Skyrocket Juniper	#15 pot	--	4
I	<i>Philadelphus x virginialis 'Minnesota Snowflake'</i>	Minnesota Snowflake Mock Orange	5" pot	--	3
J	<i>Salvia arizonica 'Deep Blue'</i>	Deep Blue Arizona Sage	5" pot	blue	7
K	<i>Salvia x sylvestris 'Blauhugel'</i>	Blue Hill Sage	5" pot	blue	16
L	<i>Thymus praecox 'Coccineus'</i>	Red Creeping Thyme	4" pot	red	30
M	<i>Picea abies 'Pendula'</i>	Weeping Norway Spruce	#5 pot	--	1
N	<i>Amelanchier utahensis</i>	Utah Serviceberry	5" pot	--	5
O	<i>Quercus gambelii</i>	Gambel Oak	5 gal	--	8
P	<i>Pinus edulis</i>	Pinyon Pine	7-8'	--	2
Q	<i>Syringa x 'Penda' BLOOMERANG</i>	Bloomerang Purple Lilac	#5 pot	purple	3
R	<i>Crataegus phaenopyrum</i>	Washington Hawthorn	#15 pot	--	1
S	<i>Pinus flexilis 'Vanderwolf's Pyramid'</i>	Vanderwolf's Pyramid Limber Pine	#6 pot	--	2
T	<i>Cercocarpus ledifolius</i>	Curl-leaf Mountain Mahogany	1 gal	--	2
U	<i>Prunus virginiana</i>	Chokecherry	#15 pot	--	2
V	<i>Pinus ponderosa</i>	Ponderosa Pine	#3 pot	--	1
W	<i>Ephedra viridis</i>	Mormon Tea	#5 pot	--	5
X	<i>Bouteloua curtipendula</i>	Sideoats Grama	1 lb.	--	20

Materials and Costs

Plants	Quantity	Size	Cost Each	Total Cost	Source
<i>Gymnocladus dioica</i> /Kentucky Coffee Tree	1	#15 pot	\$ 169.00	\$ 169.00	A
<i>Ferovskia atroplicifolia</i> / Russian Sage	10	4" pot	\$ 1.50	\$ 15.00	B
<i>Rhus aromatica</i> 'Gro-Low' /Gro-Low Sumac	7	5" pot	\$ 7.99	\$ 55.93	G
<i>Calamagrostis x acutiflora</i> 'Karl Foerster' / Karl Foerster Feather Reed Grass	40	1 gal	\$ 7.00	\$ 280.00	B
<i>Buchloe dactyloides</i> 'Cody' /Cody Buffalo Grass	1	3lb bag	\$ 39.75	\$ 39.75	H
<i>Malus domestica</i> 'Honeycrisp' / Honeycrisp Apple	1	5 gal	\$ 29.99	\$ 29.99	B
<i>Malus domestica</i> 'Gala' / Gala Apple	1	5 gal	\$ 29.99	\$ 29.99	B
<i>Juniperus scopulorum</i> 'Skyrocket' / Skyrocket Juniper	4	#15 pot	\$ 99.98	\$ 399.92	C
<i>Philadelphus lewisii</i> / Western Mock Orange	3	5" pot	\$ 7.99	\$ 23.97	G
<i>Salvia arizonica</i> 'Deep Blue' / Deep Blue Arizona Sage	7	5" pot	\$ 7.99	\$ 55.93	G
<i>Salvia x sylvestris</i> 'Blauhugel' / Blue Hill Sage	16	5" pot	\$ 7.99	\$ 127.84	G
<i>Thymus praecox</i> 'Coccineus' / Red Creeping Thyme	30	4" pot	\$ 1.50	\$ 45.00	B
<i>Picea abies</i> 'Pendula' /Weeping Norway Spruce	1	#15 pot	\$ 123.99	\$ 123.99	B
<i>Amelanchier utahensis</i> /Utah Serviceberry	5	5" pot	\$ 7.99	\$ 39.95	G
<i>Quercus gambelii</i> /Gambel Oak	8	5 gal	\$ 39.00	\$ 312.00	A
<i>Pinus edulis</i> /Pinyon Pine	2	7-8'	\$ 289.00	\$ 289.00	A
<i>Syringa x 'Penda'</i> BLOOMERANG /Bloomerang Purple Lilac	3	#5 pot	\$ 36.00	\$ 108.00	A
<i>Crataegus phaenopyrum</i> /Washington Hawthorn	1	#15 pot	\$ 169.00	\$ 169.00	A
<i>Pinus flexilis</i> 'Vanderwolf's Pyramid' / Vanderwolf's Pyramid Limber Pine	2	#5 pot	\$ 74.99	\$ 149.98	B
<i>Cercocarpus ledifolius</i> /Curl-leaf Mountain Mahogany	2	1 gal	2/\$ 9.99	\$ 9.99	J
<i>Prunus virginiana</i> /Chokecherry	2	#15 pot	\$ 210.00	\$ 420.00	A
<i>Pinus ponderosa</i> /Ponderosa Pine	1	#3 pot	\$ 26.99	\$ 26.99	B
<i>Ephedra vindsis</i> /Mormon Tea	5	#5 pot	\$ 30.00	\$ 150.00	A
<i>Bouteloua curtipendula</i> /Sideoats Grama	20	1 lb seed	\$ 10.50	\$ 210.00	H
<i>Lamium maculatum</i> /'Dead Nettle' Lamium	10	4" cup	\$ 1.50	\$ 11.50	B
<i>Athyrium</i> 'Ghost' / Ghost Fern	1	quart	\$ 16.99	\$ 16.99	E
<i>Anthemis marschalliana</i> /Rocky Mountain Columbine	7	4" cup	\$ 1.50	\$ 10.50	B
<i>Dicentra spectabilis</i> 'Gold Heart' / Gold Heart Bleeding Heart	2	4" cup	\$ 16.99	\$ 33.98	O
<i>Astilbe chinensis</i> 'Maggie Daley' / Astilbe	6	1 bulb	\$ 3.00	\$ 18.00	N
<i>Narcissus</i> / Daffodils	23	1 bulb	\$ 0	\$ 0	F
<i>Anthemis marschalliana</i> /Filigree Daisy	4	7cmx9cm pot	\$ 8.00	\$ 32.00	D
<i>Anemone hupehensis</i> / Japanese Anemone	6	1 start	\$ 0	\$ 0	F
<i>Polystichum acrostichoides</i> / Christmas Fern	2	small pot	3/\$ 8.99	\$ 8.99	N
Dryland Pasture Grass	80	1 lb seed	\$ 3.85	\$ 308.00	I
Total Plant Material Costs:			\$ 3,721.08		

Other Materials	Quantity	Size	Cost Each	Total Cost	Source
Flagstone Chips (2" depth)	10.25	cubic yard	\$ 55.00	\$ 563.75	L
Gravel Base for Flagstone Chips (3" depth)	15.25	cubic yard	\$ 18.00	\$ 274.50	L
Chips/Gravel Base Delivery	2	load	\$ 60.00	\$ 120.00	L
Weed Barrier	4	6'x100'	\$ 81.97	\$ 327.88	M
Cement for Patio (homeowners install)	252	80-lb bag	\$ 2.78	\$ 700.56	M
Fencing (8' Fence of Wood Posts and Heavy-Duty Wire, homeowners install)	posts: 17 wire: 2	4x4x10' 4x100'	\$ 18.57 \$ 69.98	\$ 315.69 \$ 139.96	M M
Raised Vegetable Beds (lumber, homeowners install)	4 13	2x6x12 2x6x10	\$ 16.00 \$ 13.00	\$ 64.00 \$ 117.00	M M
Birdbath	1	--	on hand	--	--
Bird Feeders	6-8	--	on hand	--	--
Mulch	14.5	cubic yard	\$ 29.00	\$ 420.50	L
Firepit Ring	1	4' diameter	on hand	--	--
Round Planter Pots for Shade Garden	3	15"x32"	on hand	--	--
Stepping Stones	15	varies	\$ 0.24/lb	\$ 100.00	L
Total Other Material Costs:			\$ 3,143.84		
Grand Total Costs:			\$ 6,864.92		

Key to Sources

Source	Vendor Name	Website	Phone	Physical Address
A	Big Tree Nursery	bigtreesnursery.net	435.867.0341	240 N 100 E, Kanarrville, UT
B	Lady Bug Nursery	ladybugnursery.com	435.586.3805	42 S. Westview Dr, Cedar City
C	Home Depot	homedepot.com	435.865-5305	1518 S Providence Ctr Dr, Cedar City
D	Wrightman Alpines Nursery	wrightmanalpines.com	506.529.9093	480 Brandy Cove Rd, St. Andrews, NB, Canada
E	Proven Winners	provenwinners.com	815.899.1973	111 E Elm St Ste D, Sycamore, IL
F	House we moved from in Spanish Fork	----		Spanish Fork UT
G	High Country Gardens	highcountrygardens.com	800.925.9387	----
H	Stock Seed Farms	stockseed.com	800.759.1520	28008 Mill Road, Murdock, NE
I	Great Basin Seed	greatbasinseeds.com	435.283.1411	450 South 50 East, Ephraim, UT
J	Las Pilitas Nursery	laspilitas.com	805.438.5992	3232 Las Pilitas Rd, Santa Margarita, CA
K	Red Cedar Rock Landscape Supply	redcedarrocklandscape.com	435.586.0490	1425 N. Main, Cedar City
L	Bluestone Perennials	bluestoneperennials.com	800.852.5243	----
M	Home Depot	homedepot.com	435.865.5305	1518 S. Providence Center Dr, Cedar City
N	American Meadows	americanmeadows.com	877.309.7333	2438 Shelburne Road Suite 1, Shelburne, VT